



# Dpro Series

## Product Introduction

Outdoor: P3.9 , 4.8 , 5.9    Indoor: P2.9 , 3.9 , 4.8 , 5.9



# 01

Complete Solution for Hanging, Stacking , Wall Mounting Installation and Curve System Available.



Hanging System



Wall Mounting System



Stacking System



Curve System

Concave and convex angle can reach to 12° at most.

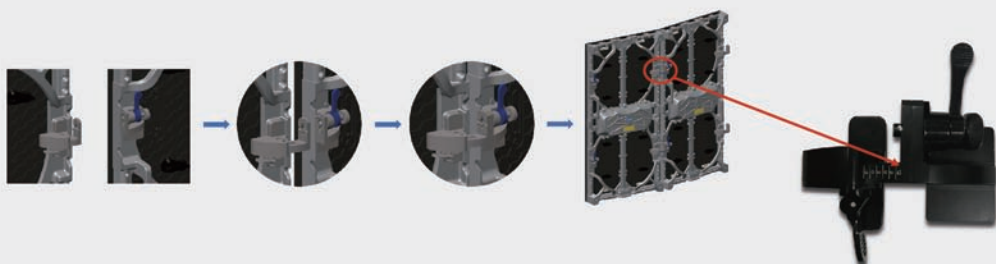

150mm at least leaving for front maintenance.

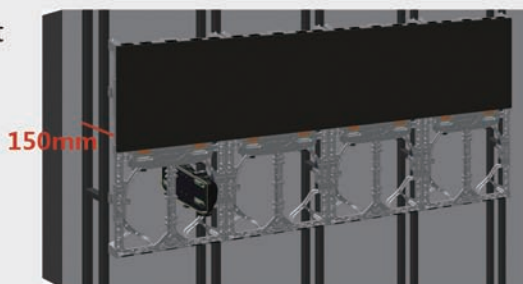

Ultra light and thin,  
one man operation.



Magnets design for quick  
hanging installation.



Positioning pins for  
precise matching.

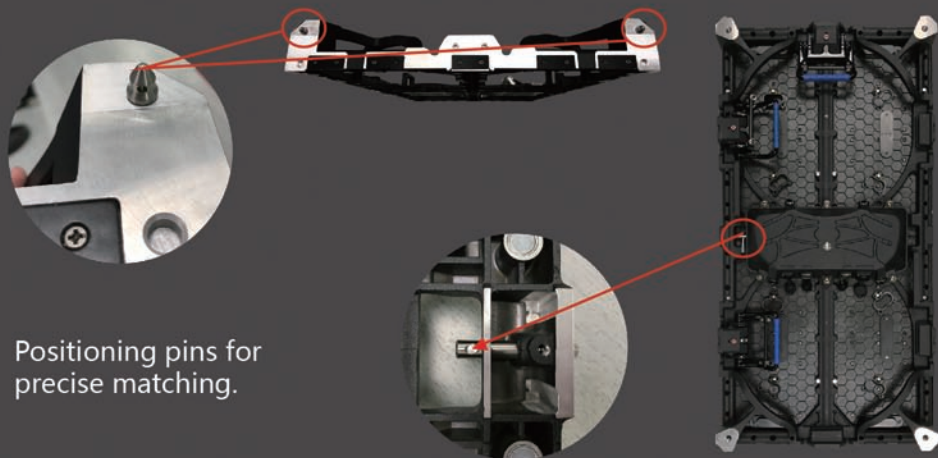



Crash Proof Design

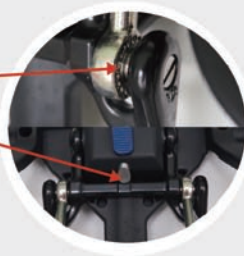
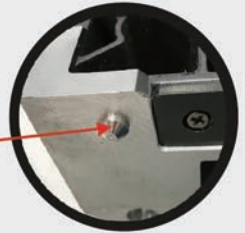
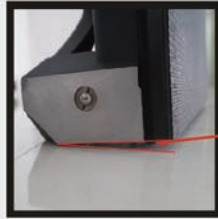

Handle locks with rotation & stop function.



Safety rope design

Both front and rear maintenance available.

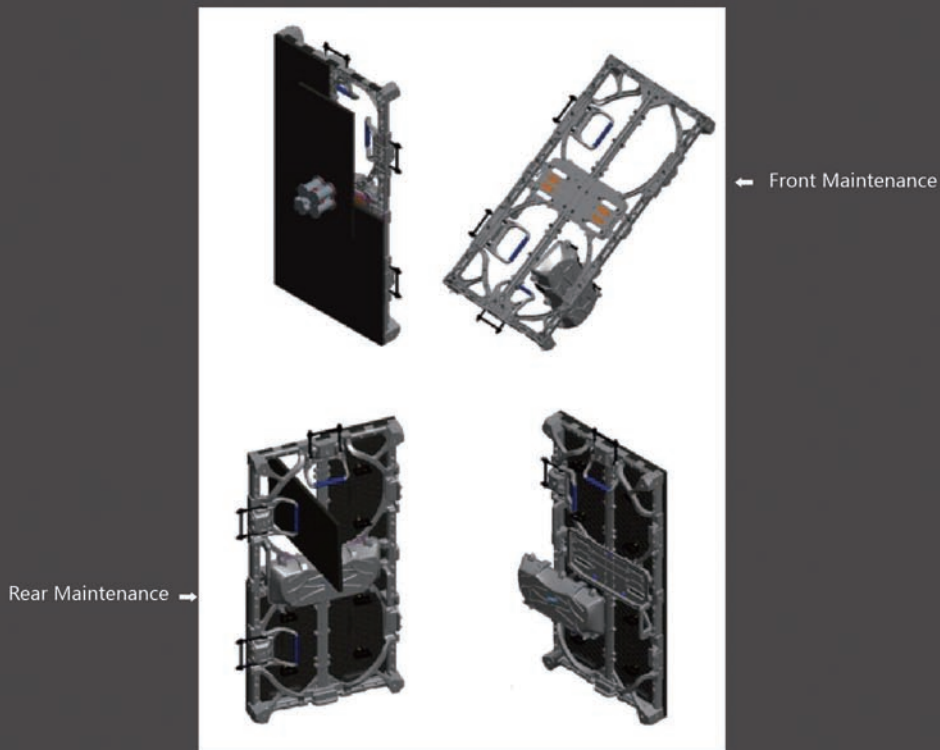

Integrated designs of control box and test button.

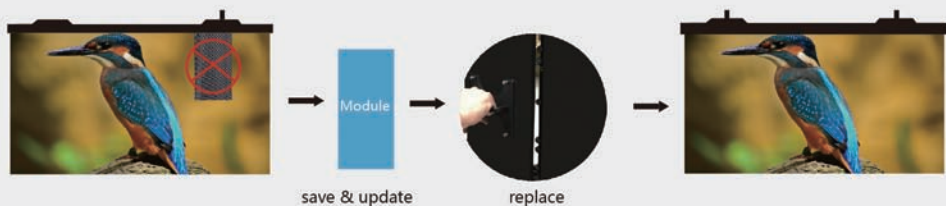

Automatic Calibration Function.  
High definition & gray scale & refresh rate.



The rubber ring structure provides better waterproof effect.



Universal modules, convenient for maintenance.

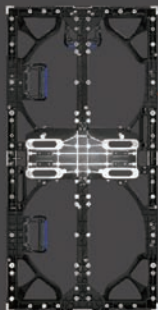

Module Model:  
 Outdoor: P3.9, P4.8, P5.9  
 Indoor: P2.9, P3.9, P4.8, P5.9

Universal cabinets, compatible with all the modules of this whole series.

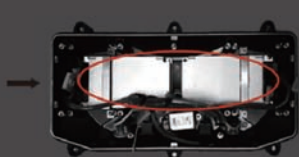

Power Supplies



Redundant power supply for receiving and hub cards.

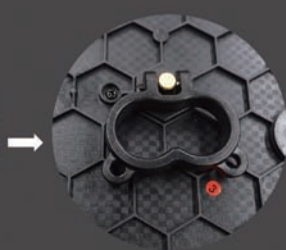
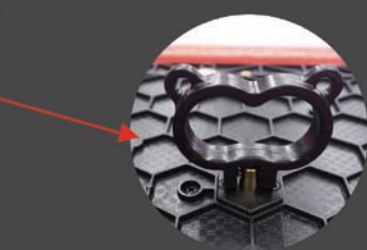

Flexible modules' handles design, saving room for packaging.



Fanless and no noise.



Die-casting aluminum, Good heat dissipation.



Interchangeable module with different pixel pitches.  
 500\*500mm and 500\*1000mm panels can be spliced with each other.  
 Front and rear maintenance.  
 Stable waterproof structure with patents.  
 Curve design & large module size ensures a perfect splicing effect.



Widely used in performances, conferences, exhibitions and other leasing activities.

## Specifications

Model	DPI2.9	DPI3.9	DPO3.9	DPO4.8	DPO5.9
Pixel Pitch	2.97mm	3.9mm	3.9mm	4.8mm	5.95mm
LED Type	Black SMD2121	Black SMD2121	SMD1921	SMD1921	SMD1921
Module Size(WxH)	250x500mm	250x500mm	250x500mm	250x500mm	250x500mm
Panel Size	500x500x88mm 500x1000x88mm	500x500x88mm 500x1000x88mm	500x500x88mm 500x1000x88mm	500x500x88mm 500x1000x88mm	500x500x88mm 500x1000x88mm
Panel Pixel	168x168dots 168x336dots	128x128dots 128x256dots	128x128dots 128x256dots	104x104dots 104x208dots	84x84dots 84x168dots
Panel Material	Aluminum	Aluminum	Aluminum	Aluminum	Aluminum
Panel Weight	10.7Kg 17.8Kg	10.6Kg 17.8Kg	11.4Kg 18.7Kg	10.6Kg 17.8Kg	10.7Kg 17.8Kg
Brightness	1200nit	1200nit	5000nit	5000nit	5000nit
Processing depth	14-16bit	14-16bit	14-16bit	14-16bit	14-16bit
Display refresh rate	2880Hz	1920Hz	1920Hz	1920Hz	1920Hz
Viewing angle(H/V)	140°/120°	140°/120°	140°/75°	140°/110°	140°/110°
Power Consumption (Max./Avg.)	640/213W/㎡	640/213W/㎡	640/213W/㎡	640/213W/㎡	640/213W/㎡
IP Rating (Front/Rear)	IP30/IP30	IP30/IP30	IP65/IP54	IP65/IP54	IP65/IP54
Panel maintenanceType	Front & Rear Maintenance				



[www.pekason.com](http://www.pekason.com)